

ExpressVote® Universal Voting System

BALLOT MARKING DEVICE

Enhance Your Voting Experience ~
Vote using a *Touch Screen*

This will Mark & Print Your
PAPER BALLOT for you!

FOR USE BY ALL VOTERS
ALSO HAS ADA CAPABILITIES



The ExpressVote Machine

Each precinct will have a “Machine” sitting at it for voters to use.
This is the State’s answer to an ADA (Americans with Disabilities) Machine.

*This machine *replaces* the old, BIG AutoMarks
(my pollworkers who have worked before will remember that BIG machine that sat at your polling places..... you remember, THAT THING THAT NO ONE USED!)



The ExpressVote uses a PAPER ballot, so it is NOT voting Electronically! It is just simply a BALLOT MARKING DEVICE.

ANY voter can use this..... we may have some younger people who WANT to use the touchscreen to vote. It is very user friendly, and actually quite fun to vote on. AND, bonus – if you run out of any ballot types at your precinct, all of your ballot options are on this machine!

In the next few pages, please find information you’ll need to know about our ExpressVote....

ExpressVote Supplies (white box)

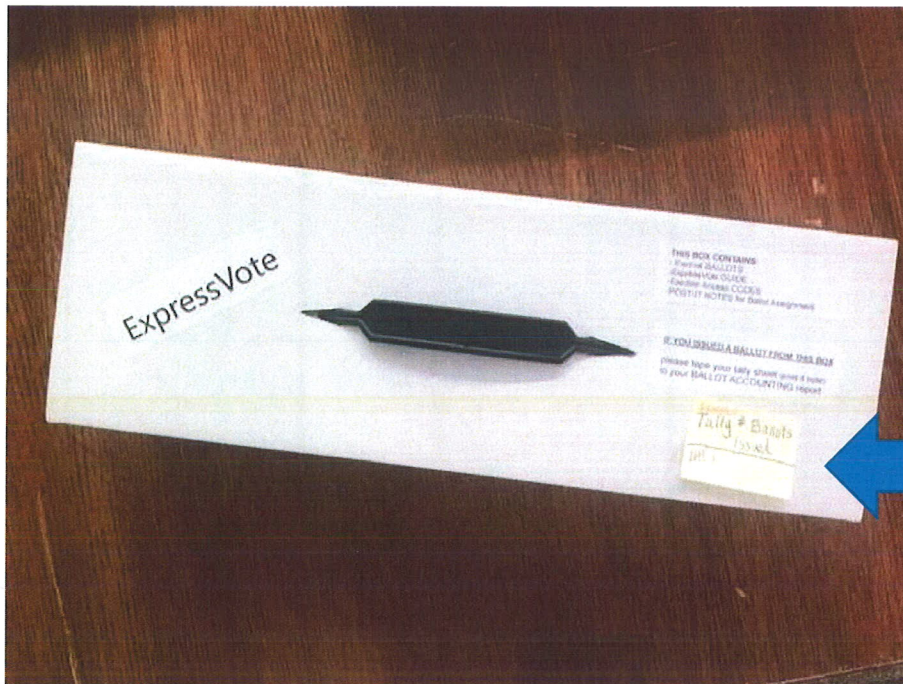

Please note this is where you'll keep "tally" of the # of thermal ballots issued from this box

Contents :

ExpressVote user guide will be in the white box, along with....

Thermal Ballots

Post-it notes

Election Codes worksheet

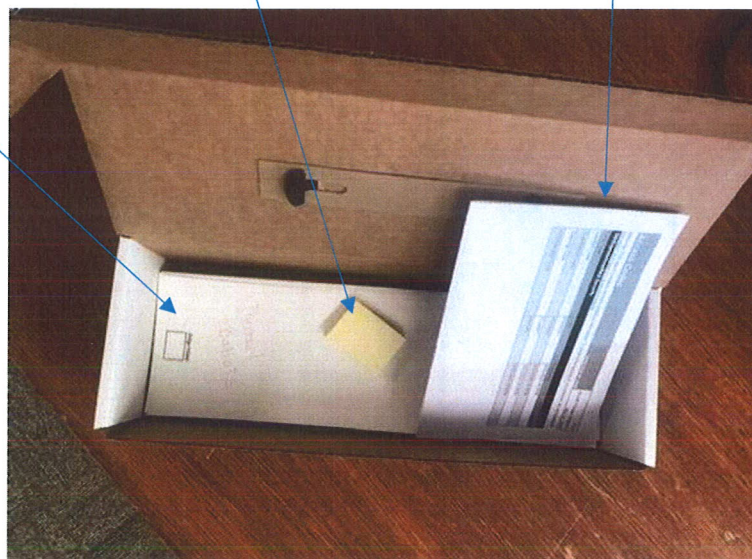

Preparing the ExpressVote for Use

(DO THIS AT THE BEGINNING OF YOUR DAY)

Pollworker's Instructions:

- 1) Plug-in Surge protector @ wall outlet & make sure the surge protector is "on"
- 2) Get the key from small side pocket of black carrying case bag.
- 3) Open left access compartment of ExpressVote (see diagram)
- 4) Switch POWER mode to "On"you'll hear it power on
- 5) Check that MODE toggle is set to "Voter" (if not, go ahead and set it to "voter")
- 6) Watch the screen.... Enter the "ELECTION CODE" when prompted.
"ELECTION CODE" is on the ACCESS CODE worksheet in white box.
- 7) Lock Side Access Compartment
- 8) Put key back away in small side pocket of black carrying case bag.

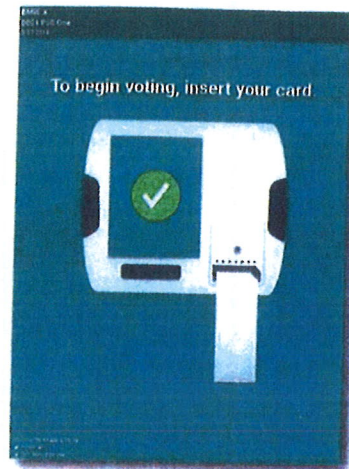

The screen should look like picture above.....It is now powered up and ready ~ GOOD JOB!

Now you will leave your ExpressVote sit as is until a Voter uses it

ExpressVote® Universal Voting System

Product Overview & ExpressVote Components

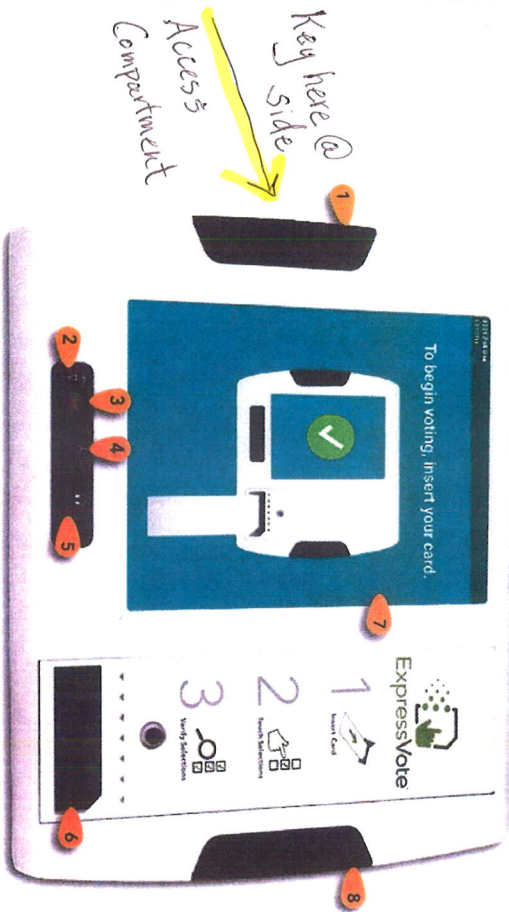

The ExpressVote Universal Voting System as a Ballot Marking Device is designed to capture and mark voting cards for all voters. The ExpressVote concept reduces voting time, enhances the voting experience, and provides voting access for those who require it.

ExpressVote Components

- 1 Access compartment
- 2 Power source indicator
- 3 Battery status indicator
- 4 Accessibility device port
- 5 Headphone jack
- 6 Paper ballot feed
- 7 Touch screen
- 8 Paper Path Access Compartment

Access Compartment Components

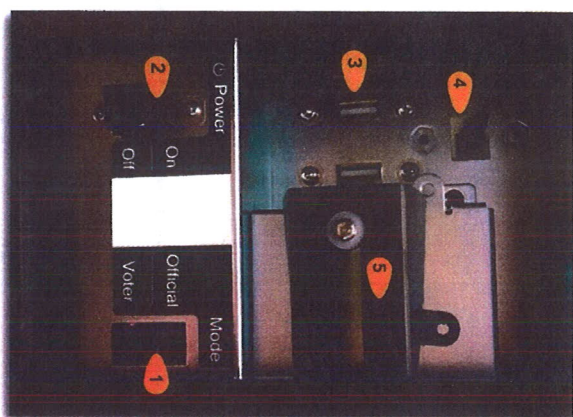

Power

Mode

- 1 Mode switch
- 2 Power switch
- 3 USB ports
- 4 Audio-tactile keypad jack
- 5 Sliding protective USB port cover

Issuing an ExpressVote Thermal Ballot

Worker A:

- 1) give the Voter a Privacy Sleeve
- 2) Get the Ballot Assignment (written on a Post-It) from Clerk
- 3) Remove a Thermal Ballot from the Box, place the post-it on it & initial your ballot
*your initials are confirming that you have the Ballot Assignment you'll need @ the Machine
- 4) Record a 'tally mark' on Thermal Ballot Box for your ballots issued counted
you'll need a total # for your ballot count report at end of night
- 5) hand the Thermal Ballot (with the Ballot Assignment post-it affixed) to Worker B

Worker B:

- 1) Make sure you have the Thermal Ballot (with the Ballot Assignment post-it affixed)
- 2) Make sure the voter has the Privacy Sleeve
- 3) Walk the Voter to the ExpressVote Machine
- 4) initial the Thermal Ballot & remove the Post-it Note
*this 2nd set of initials confirms that you know the Ballot Assignment, you'll have to select this on the next page when you Initiate the Vote Session
- 5) Follow instructions on the next page: **INITIATING A VOTE SESSION**

Vote Session Initiation and Controls

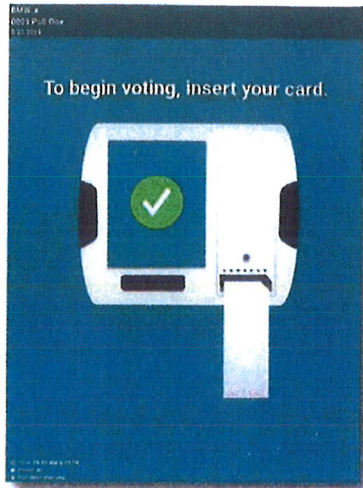

INITIATING A VOTE SESSION

- Insert the blank Thermal Ballot into the machine.
*note correct way: upper right corner is angled
- Make your "Ballot Style" selection(s) for the Voter's Ballot
*see your post-it

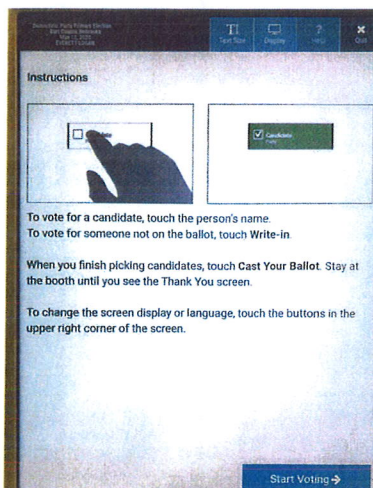

- when the 'Instructions' page loads, you are done
*you'll see a blue box "start voting" @ bottom right
- Turn the page of this guide to: Voter Instructions
Walk away
to allow Voter to Vote in Privacy

VOTER INSTRUCTIONS

*** TO VOTE: follow the on-screen instructions**

Voting on the ExpressVote

Page 1 of 2

Vote Using Touch Screen

On the voting screens, touch the candidate or other contest choice to select. If there are more candidates than will fit on the screen, press the yellow **More** bar at the bottom of the screen to see remaining candidates.

To navigate between contests, touch the **Next** or **Previous** buttons in the Navigation Bar.

For contests allowing write-in votes, touch the **Write-in** option and use the on-screen keyboard to enter your write-in name. Touch **Accept**.

Print Ballot

Return to Ballot

1 of 1

Editing Vote Selections & Printing a Ballot

Once all selections have been entered, the Verify Selections screen will display a summary of your ballot selections.

If needed, touch the contest for which you wish to make changes. Make the desired changes, and return to the Verify Selections screen.

When done verifying selections, the Print Card screen displays. Touch **Print Ballot** to print the completed ballot onto the activation card.

When you've finished, your Ballot will EJECT -
The THANK YOU SCREEN will appear.

Remove your Ballot & Slide it into the Privacy Sleeve (*with initials showing please*)
Deposit your Ballot into the Ballot Box back at your Precinct table.

Get your "I VOTED" sticker 😊

Voter's HOW-TO for using KEYPAD CONTROLS

(if you choose)

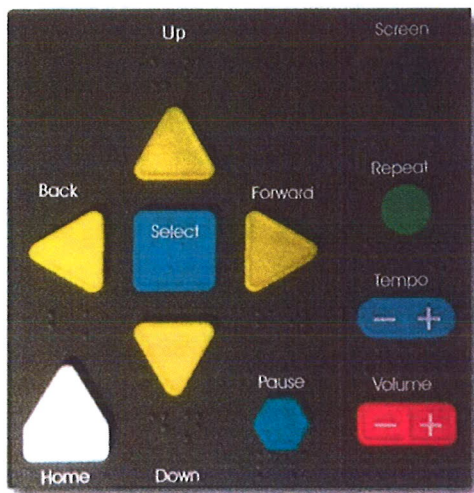

Audio-Tactile Keypad Controls

Button	Description
Up Arrow	Moves the cursor up the screen menu.
Back Arrow	Moves to the previous screen.
Select	Selects the voter's contest choices.
Forward Arrow	Advances to next screen.
Down Arrow	Opens screen with voting instructions.
Home	Opens screen with voting instructions.
Pause	Stops the audio message momentarily.
Screen	Darkens the monitor for privacy viewing.
Repeat	Repeats the last spoken phrase of audio.
Tempo	Adjusts the audio speed.
Volume	Adjusts the audio level.

More information: *ExpressVote Operator's Guide*, p. 60

End of Day

Powering Down the ExpressVote



Powering Down

Using the barrel key, open the Access Compartment and set the Power Switch to **Off**.

Lock the Access Compartment door and remove the key.

Ensure all doors on the machine are locked.

Unplug the power cord from the ExpressVote system.

